

| REV. | DATE | ECO | DESCRIPTION | BY | CK | APP |
|------|-----------|-------|-----------------------------|-----|-----|---------|
| A | 3/15/2023 | 16668 | INITIAL RELEASE | MAR | N/A | SEE ECO |
| B | 9/20/2024 | 18711 | ADDED TYPE, DIM .81[20.6] | YF | N/A | SEE ECO |
| C | 1/8/2025 | 18967 | ADDED DIM .43±.01[10.9±0.3] | LA | N/A | SEE ECO |

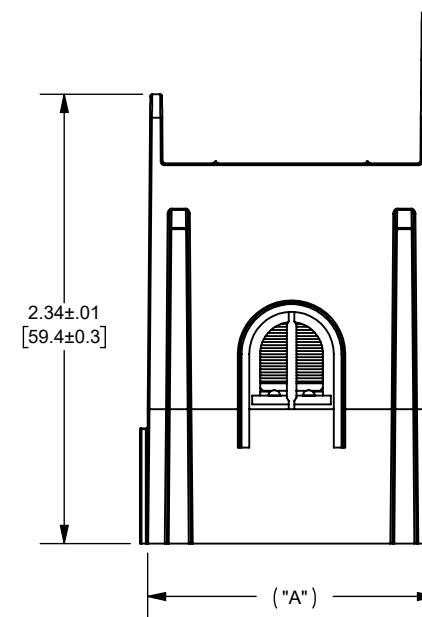
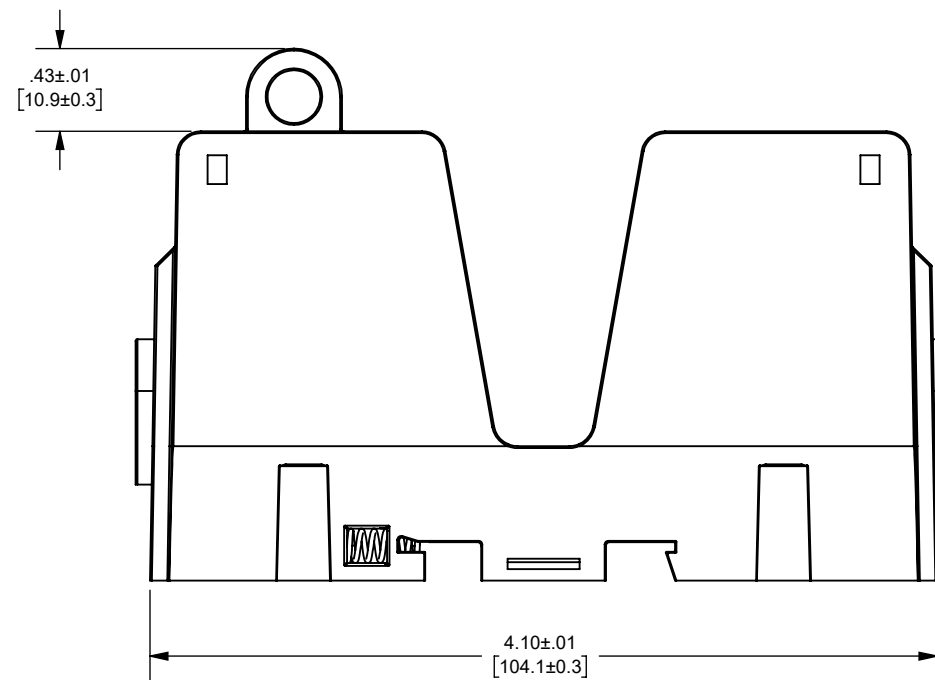
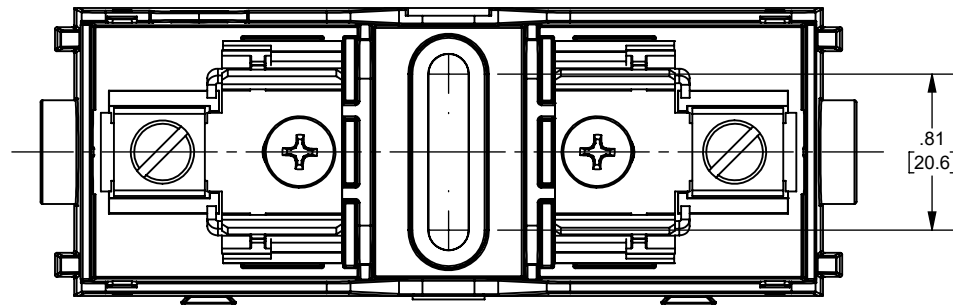

OUTLINE DIMENSIONS
NOT TO BE USED FOR PRODUCTION DIMENSIONS IN [] ARE MILLIMETERS

| | | | |
|---|--|--|-------------------------|
| Approval stage / Etat d'approbation: APPROUVÉ POUR FABRICATION / APPROVED FOR MANUFACTURING | | Product Class:/ Product Type: CLASS J FUSEHOLDER | |
| Initial ECO / ECO intiale: ECO-16668-000 | | Product amp rating:/ Voltage rating: 60A 600V | |
| Draw by / Dessiné par: Luis ARMENTA | Date : 1/20/2025 | Title / Titre: OUTLINE FB60J60B(1-3) | Weight : Masse : |
| Checked by / Vérifié par: Yadyra Fang | Date : 1/21/2025 | Drawing / de dessin: OUT-380446 | Rev : Rév : C |
| Electrical Power 374 MERRIMAC STREET NEWBURYPORT, MA 01950 | Éch / Scale : 1:1 Format / Size : B | Part / Article: SEE TABLE | Page : 1/1 |

| CATALOG NUMBER | NUMBER OF POLES | "A" DIMENSION |
|----------------|-----------------|------------------------|
| FB60J60B3 | 3 | 4.500±.030 [114.3±0.9] |
| FB60J60B2 | 2 | 3.000±.020 [76.2±0.6] |
| FB60J60B1 | 1 | 1.500±.010 [38.1±0.3] |

Ce plan strictement confidentiel est la propriété exclusive de la société MERSEN sans l'autorisation écrite de laquelle il ne peut être ni reproduit, ni copié, ni communiqué à des tiers.
This drawing and specifications there on is property of MERSEN and shall not be reproduced or copied or used in whole or in part as the base for manufacture or sale of item without written permission.

